

# B250003

# XA



- ▶ 主要技术特性 (Main Specifications)
- ▶ 适用导线规格 (Applicable wire) : AWG30#~24#
- ▶ 适用基板厚度 (Applicable PC board thickness) : 1.2mm~1.6mm
- ▶ 温度范围 (Temperature range) : -25°C~+85°C
- ▶ 额定电压 (Voltage rating) : 250V AC, DC
- ▶ 额定电流 (Current rating) : 2A AC, DC
- ▶ 接触电阻 (Contact resistance) :  $\leq 0.02\Omega$
- ▶ 绝缘电阻 (Insulation resistance) :  $\geq 1000M\Omega$
- ▶ 耐压 (Withstanding voltage) : 1000V AC/minute

### 材料及电镀规格 Material and Finish

型号 Type	材料 Material	材料厚度 Material Thickness	电镀规格 Finish
插座 WAFER	塑胶 HOUSING	PA66 UL94V-0	N/A
	针PIN	黄铜 Brass	镀锡 Tin-plated
孔座 HOUSING	PA66 UL94V-0	—	N/A
端子 TERMINAL	锡青铜 Phosphor bronze	0.2mm	镀锡 Tin-plated

### 产品尺寸图 Product size chart

 单位: mm 一般公差:  $\pm 0.20$ 

### TERMINAL

B250003-4 XA

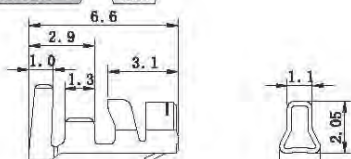

### 安装尺寸 (Mounting measurement)

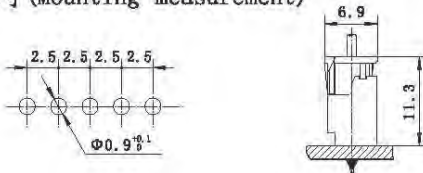

### HOUSING

B250003-2

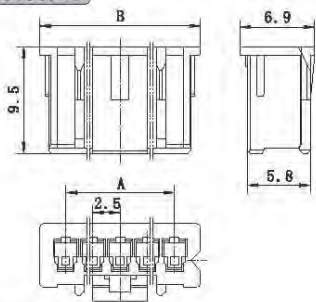

### WAFER

B250003-1

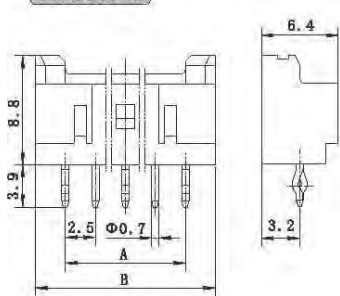

B250003-1A

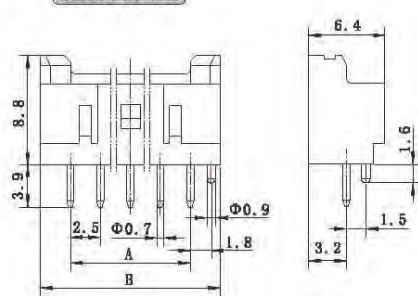

### HOUSING

极数 Circuits	型号 Type	尺寸 (Dimensions) mm		备注型号 P. S. Type
		A	B	
2	B250003-2-02	2.5	7.3	XA-02Y
3	B250003-2-03	5.0	9.8	XA-03Y
4	B250003-2-04	7.5	12.3	XA-04Y
5	B250003-2-05	10.0	14.8	XA-05Y
6	B250003-2-06	12.5	17.3	XA-06Y
7	B250003-2-07	15.0	19.8	XA-07Y
8	B250003-2-08	17.5	22.3	XA-08Y
9	B250003-2-09	20.0	24.8	XA-09Y
10	B250003-2-10	22.5	27.3	XA-10Y
11	B250003-2-11	25.0	29.8	XA-11Y

# B250003

# XA

## WAFER

极数 Circuits	型号 Type		尺寸(Dimensions)mm		备注型号 P. S. Type	
			A	B		
2	B250003-1-02	B250003-1A-02	2.5	7.5	XA-02A	XA-02ADW
3	B250003-1-03	B250003-1A-03	5.0	10.0	XA-03A	XA-03ADW
4	B250003-1-04	B250003-1A-04	7.5	12.5	XA-04A	XA-04ADW
5	B250003-1-05	B250003-1A-05	10.0	15.0	XA-05A	XA-05ADW
6	B250003-1-06	B250003-1A-06	12.5	17.5	XA-06A	XA-06ADW
7	B250003-1-07	B250003-1A-07	15.0	20.0	XA-07A	XA-07ADW
8	B250003-1-08	B250003-1A-08	17.5	22.5	XA-08A	XA-08ADW
9	B250003-1-09	B250003-1A-09	20.0	25.0	XA-09A	XA-09ADW
10	B250003-1-10	B250003-1A-10	22.5	27.5	XA-10A	XA-10ADW
11	B250003-1-11	B250003-1A-11	25.0	30.0	XA-11A	XA-11ADW

## WAFER

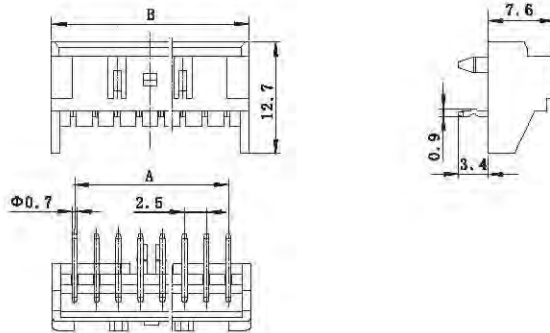
**B250001-1WD**

## WAFER

极数 Circuits	型号 Type		尺寸(Dimensions)mm		备注型号 P. S. Type	
			A	B		
2	B250003-1WD-02	B250003-1A-02	2.5	7.5	XA-02AWD	
3	B250003-1WD-03	B250003-1A-03	5.0	10.0	XA-03AWD	
4	B250003-1WD-04	B250003-1A-04	7.5	12.5	XA-04AWD	
5	B250003-1WD-05	B250003-1A-05	10.0	15.0	XA-05AWD	
6	B250003-1WD-06	B250003-1A-06	12.5	17.5	XA-06AWD	
7	B250003-1WD-07	B250003-1A-07	15.0	20.0	XA-07AWD	
8	B250003-1WD-08	B250003-1A-08	17.5	22.5	XA-08AWD	
9	B250003-1WD-09	B250003-1A-09	20.0	25.0	XA-09AWD	
10	B250003-1WD-10	B250003-1A-10	22.5	27.5	XA-10AWD	
11	B250003-1WD-11	B250003-1A-11	25.0	30.0	XA-11AWD	

## HOUSING

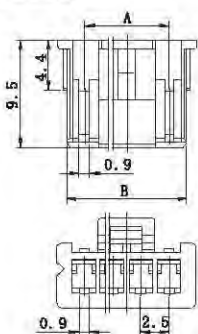
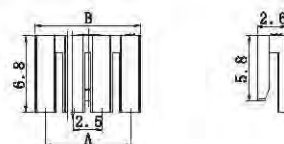
**B250003-2B**

**B250003-5B**

# B250003

# XA

## HOUSING

极数 Circuits	型号 Type	尺寸 (Dimensions) mm		备注型号 P. S. Type
		A	B	
2	B250003-2B-02	2.5	5.6	XAB-02Y
3	B250003-2B-03	5.0	8.1	XAB-03Y
4	B250003-2B-04	7.5	10.6	XAB-04Y
5	B250003-2B-05	10.0	13.1	XAB-05Y
6	B250003-2B-06	12.5	15.6	XAB-06Y
7	B250003-2B-07	15.0	18.1	XAB-07Y
8	B250003-2B-08	17.5	20.6	XAB-08Y
9	B250003-2B-09	20.0	23.1	XAB-09Y
10	B250003-2B-10	22.5	25.6	XAB-10Y
11	B250003-2B-11	25.0	28.1	XAB-11Y

## HOUSING

极数 Circuits	型号 Type	尺寸 (Dimensions) mm		备注型号 P. S. Type
		A	B	
2	B250003-5B-02	2.5	4.4	XAB-02RST
3	B250003-5B-03	5.0	6.9	XAB-03RST
4	B250003-5B-04	7.5	9.4	XAB-04RST
5	B250003-5B-05	10.0	11.9	XAB-05RST
6	B250003-5B-06	12.5	14.4	XAB-06RST
7	B250003-5B-07	15.0	16.9	XAB-07RST
8	B250003-5B-08	17.5	19.4	XAB-08RST
9	B250003-5B-09	20.0	21.9	XAB-09RST
10	B250003-5B-10	22.5	24.4	XAB-10RST
11	B250003-5B-11	25.0	26.9	XAB-11RST

## HOUSING

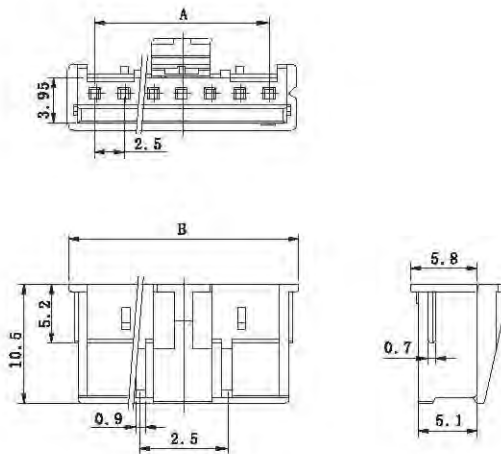
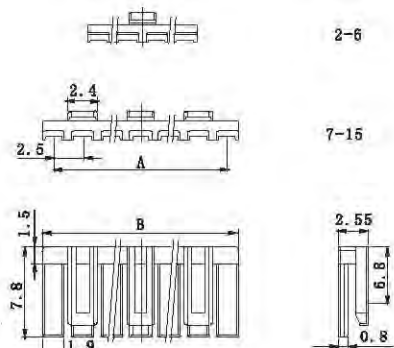
**B250003-2C**

**B250003-5C**

# B250003

# XA

## HOUSING

极数 Circuits	型号 Type	尺寸(Dimensions)mm		备注型号 P. S. Type
		A	B	
4	B250003-2C-04	7.5	12.3	XAC-04Y
5	B250003-2C-05	10.0	14.8	XAC-05Y
6	B250003-2C-06	12.5	17.3	XAC-06Y
7	B250003-2C-07	15.0	19.8	XAC-07Y
8	B250003-2C-08	17.5	22.3	XAC-08Y
9	B250003-2C-09	20.0	24.8	XAC-09Y
10	B250003-2C-10	22.5	27.3	XAC-10Y
11	B250003-2C-11	25.0	29.8	XAC-11Y
15	B250003-2C-15	35.0	39.8	XAC-15Y

## HOUSING

极数 Circuits	型号 Type	尺寸(Dimensions)mm		备注型号 P. S. Type
		A	B	
2	B250003-5C-02	2.5	4.4	XAC-02RST
3	B250003-5C-03	5.0	6.9	XAC-03RST
4	B250003-5C-04	7.5	9.4	XAC-04RST
5	B250003-5C-05	10.0	11.9	XAC-05RST
6	B250003-5C-06	12.5	14.4	XAC-06RST
7	B250003-5C-07	15.0	16.9	XAC-07RST
8	B250003-5C-08	17.5	19.4	XAC-08RST
9	B250003-5C-09	20.0	21.9	XAC-09RST
10	B250003-5C-10	22.5	24.4	XAC-10RST
11	B250003-5C-11	25.0	26.9	XAC-11RST
15	B250003-5C-15	35.0	36.9	XAC-15RST

## HOUSING

B250003-2C-02Y XAC-02Y

B250003-2C-03Y XAC-03Y

