

B420001

5557

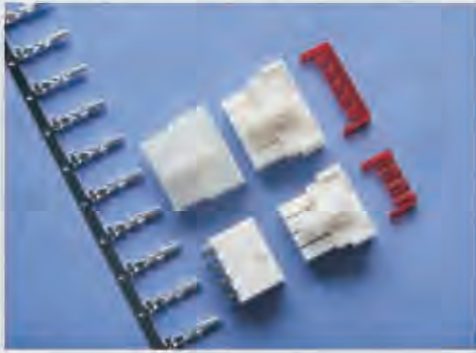

► 主要技术特性 (Main Specifications)

- 适用导线规格 (Applicable wire) : AWG24#~18#
- 适用基板厚度 (Applicable PC board thickness) : 1.2mm~1.6mm
- 温度范围 (Temperature range) : -25°C~+85°C
- 额定电压 (Voltage rating) : 250V AC, DC
- 额定电流 (Current rating) : 5A AC, DC
- 接触电阻 (Contact resistance) : $\leq 0.02\Omega$
- 绝缘电阻 (Insulation resistance) : $\geq 1000M\Omega$
- 耐压 (Withstanding voltage) : 1500V AC/minute

材料及电镀规格 Material and Finish

| 型号 Type | 材料 Material | 材料厚度 Material Thickness | 电镀规格 Finish |
|-------------|---------------------|-------------------------|---------------|
| 插座 WAFER | 塑胶 HOUSING | PA66 UL94V-0 | N/A |
| | 针PIN | 黄铜 Brass | 镀锡 Tin-plated |
| 孔座 HOUSING | PA66 UL94V-0 | — | N/A |
| 端子 TERMINAL | 锡青铜 Phosphor bronze | 0.2mm/0.22mm | 镀锡 Tin-plated |

产品尺寸图 Product size chart

 单位: mm 一般公差: ± 0.20

TERMINAL

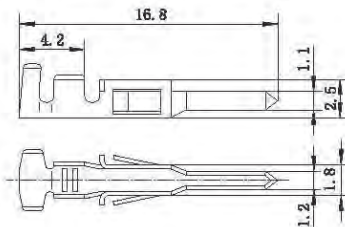
B420001-3 5557-A

HOUSING

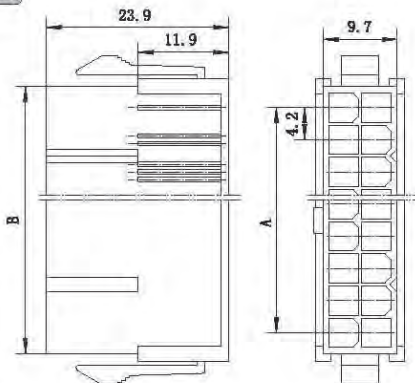
B420001-1

WAFER

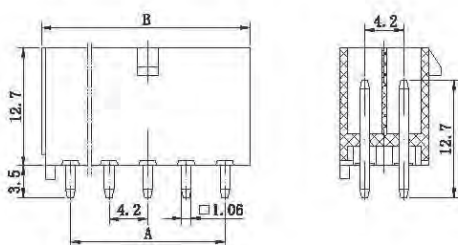
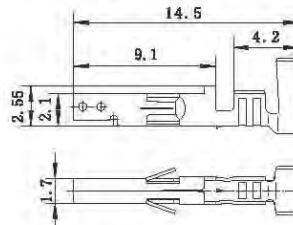
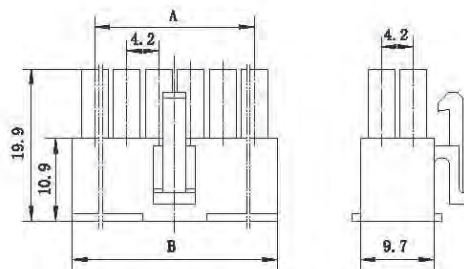
B420001-1A

B420001-4 5556-Y

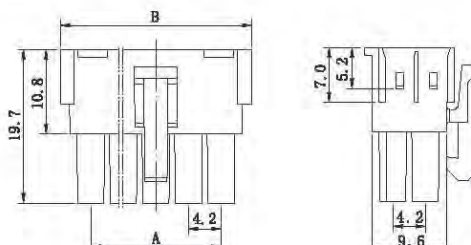
B420001-2

HOUSING

B420001-2B

B420001

5557

HOUSING

| 极数 Circuits | 型号 Type | 尺寸(Dimensions)mm | | 备注型号 P. S. Type |
|----------------|--------------|------------------|------|--------------------|
| | | A | B | |
| 2 | B420001-1-02 | 4.2 | 9.8 | 5557-02R |
| 3 | B420001-1-03 | 8.4 | 14.0 | 5557-03R |
| 4 | B420001-1-04 | 4.2 | 9.8 | 5557-04R |
| 6 | B420001-1-06 | 8.4 | 14.0 | 5557-06R |
| 8 | B420001-1-08 | 12.6 | 18.2 | 5557-08R |
| 10 | B420001-1-10 | 16.8 | 22.4 | 5557-10R |
| 12 | B420001-1-12 | 21.0 | 26.6 | 5557-12R |
| 14 | B420001-1-14 | 25.2 | 30.8 | 5557-14R |
| 16 | B420001-1-16 | 29.4 | 35.0 | 5557-16R |
| 18 | B420001-1-18 | 33.6 | 39.2 | 5557-18R |
| 20 | B420001-1-20 | 37.8 | 43.4 | 5557-20R |

| 极数 Circuits | 型号 Type | 尺寸(Dimensions)mm | | 备注型号 P. S. Type |
|----------------|--------------|------------------|------|--------------------|
| | | A | B | |
| 2 | B420001-2-02 | 4.2 | 9.8 | 5557-02P |
| 3 | B420001-2-03 | 8.4 | 14.0 | 5557-03P |
| 4 | B420001-2-04 | 4.2 | 9.8 | 5557-04P |
| 6 | B420001-2-06 | 8.4 | 14.0 | 5557-06P |
| 8 | B420001-2-08 | 12.6 | 18.2 | 5557-08P |
| 10 | B420001-2-10 | 16.8 | 22.4 | 5557-10P |
| 12 | B420001-2-12 | 21.0 | 26.6 | 5557-12P |
| 14 | B420001-2-14 | 25.2 | 30.8 | 5557-14P |
| 16 | B420001-2-16 | 29.4 | 35.0 | 5557-16P |
| 18 | B420001-2-18 | 33.6 | 39.2 | 5557-18P |
| 20 | B420001-2-20 | 37.8 | 43.4 | 5557-20P |

WAFER

| 极数 Circuits | 型号 Type | 尺寸(Dimensions)mm | | 备注型号 P. S. Type |
|----------------|---------------|------------------|------|--------------------|
| | | A | B | |
| 4 | B420001-1A-04 | 4.2 | 9.7 | 5557-04A |
| 6 | B420001-1A-06 | 8.4 | 13.9 | 5557-06A |
| 8 | B420001-1A-08 | 12.6 | 18.1 | 5557-08A |
| 10 | B420001-1A-10 | 16.8 | 22.3 | 5557-10A |
| 12 | B420001-1A-12 | 21.0 | 26.5 | 5557-12A |
| 14 | B420001-1A-14 | 25.2 | 30.7 | 5557-14A |
| 16 | B420001-1A-16 | 29.4 | 34.9 | 5557-16A |
| 18 | B420001-1A-18 | 33.6 | 39.1 | 5557-18A |
| 20 | B420001-1A-20 | 37.8 | 43.3 | 5557-20A |

HOUSING

| 极数 Circuits | 型号 Type | 尺寸(Dimensions)mm | | 备注型号 P. S. Type |
|----------------|---------------|------------------|------|--------------------|
| | | A | B | |
| 4 | B420001-2B-04 | 4.2 | 12.1 | 5557-04PB |
| 6 | B420001-2B-06 | 8.4 | 16.3 | 5557-06PB |
| 8 | B420001-2B-08 | 12.6 | 20.5 | 5557-08PB |
| 10 | B420001-2B-10 | 16.8 | 24.7 | 5557-10PB |
| 12 | B420001-2B-12 | 21.0 | 28.9 | 5557-12PB |
| 14 | B420001-2B-14 | 25.2 | 33.1 | 5557-14PB |
| 16 | B420001-2B-16 | 29.4 | 37.3 | 5557-16PB |
| 18 | B420001-2B-18 | 33.6 | 41.5 | 5557-18PB |
| 20 | B420001-2B-20 | 37.8 | 45.7 | 5557-20PB |

HOUSING

B420001-5

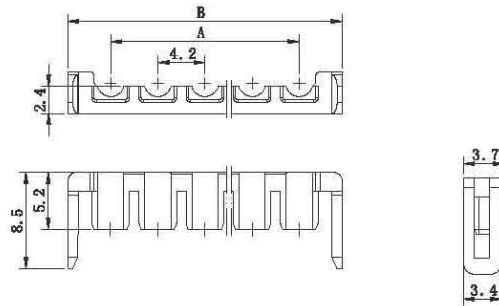

HOUSING

| 极数 Circuits | 型号 Type | 尺寸(Dimensions)mm | | 备注型号 P. S. Type |
|----------------|--------------|------------------|------|--------------------|
| | | A | B | |
| 2 | B420001-5-02 | 4.2 | 11.8 | 5557-02RST |
| 3 | B420001-5-03 | 8.4 | 16.0 | 5557-03RST |
| 4 | B420001-5-04 | 12.6 | 20.2 | 5557-04RST |
| 5 | B420001-5-05 | 16.8 | 24.4 | 5557-05RST |
| 6 | B420001-5-06 | 21.0 | 28.6 | 5557-06RST |
| 7 | B420001-5-07 | 25.2 | 32.8 | 5557-07RST |
| 8 | B420001-5-08 | 29.4 | 37.0 | 5557-08RST |
| 9 | B420001-5-09 | 33.6 | 41.2 | 5557-09RST |
| 10 | B420001-5-10 | 37.8 | 45.4 | 5557-10RST |